

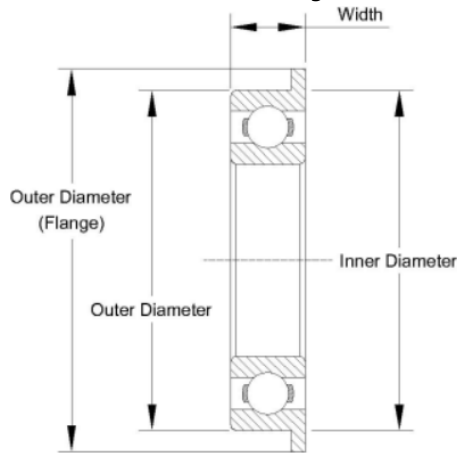

SF Series Stainless Steel Flanged Miniature Bearings



Part Number	Bore diameter	Outside diameter	Width	Flange outer diameter	Flange thickness	Seal type	Ring material	Ball material	Limiting speed
SF681	1 mm	3 mm	1 mm	3.8 mm	0.3 mm	Open	Stainless Steel	Stainless Steel	117 X 1000 rpm
SF691	1 mm	4 mm	1.6 mm	5 mm	0.5 mm	Open	Stainless Steel	Stainless Steel	90 X 1000 rpm
SF681x	1.5 mm	4 mm	1.2 mm	5 mm	0.4 mm	Open	Stainless Steel	Stainless Steel	90 X 1000 rpm
SF681xzz	1.5 mm	4 mm	2 mm	5 mm	0.6 mm	Shielded	Stainless Steel	Stainless Steel	90 X 1000 rpm
SF691x	1.5 mm	5 mm	2 mm	6.5 mm	0.6 mm	Open	Stainless Steel	Stainless Steel	76.5 X 1000 rpm
SF691xzz	1.5 mm	5 mm	2.6 mm	6.5 mm	0.8 mm	Shielded	Stainless Steel	Stainless Steel	76.5 X 1000 rpm
SF601x	1.5 mm	6 mm	2.5 mm	7.5 mm	0.6 mm	Open	Stainless Steel	Stainless Steel	67.5 X 1000 rpm
SF601xzz	1.5 mm	6 mm	3 mm	7.5 mm	0.8 mm	Shielded	Stainless Steel	Stainless Steel	67.5 X 1000 rpm
SF682	2 mm	5 mm	1.5 mm	6.1 mm	0.5 mm	Open	Stainless Steel	Stainless Steel	76.5 X 1000 rpm
SF682rs	2 mm	5 mm	2.3 mm	6.1 mm	0.6 mm	Sealed	Stainless Steel	Stainless Steel	76.5 X 1000 rpm
SF682zz	2 mm	5 mm	2.3 mm	6.1 mm	0.6 mm	Shielded	Stainless Steel	Stainless Steel	76.5 X 1000 rpm
SF692	2 mm	6 mm	2.3 mm	7.5 mm	0.6 mm	Open	Stainless Steel	Stainless Steel	67.5 X 1000 rpm
SF692rs	2 mm	6 mm	3 mm	7.5 mm	0.8 mm	Sealed	Stainless Steel	Stainless Steel	67.5 X 1000 rpm
SF692zz	2 mm	6 mm	3 mm	7.5 mm	0.8 mm	Shielded	Stainless Steel	Stainless Steel	67.5 X 1000 rpm
SF602	2 mm	7 mm	2.8 mm	8.5 mm	0.7 mm	Open	Stainless Steel	Stainless Steel	54 X 1000 rpm
SF602rs	2 mm	7 mm	3.5 mm	8.5 mm	0.9 mm	Sealed	Stainless Steel	Stainless Steel	54 X 1000 rpm
SF602zz	2 mm	7 mm	3.5 mm	8.5 mm	0.9 mm	Shielded	Stainless Steel	Stainless Steel	54 X 1000 rpm
SF682x	2.5 mm	6 mm	1.8 mm	7.1 mm	0.5 mm	Open	Stainless Steel	Stainless Steel	63.9 X 1000 rpm
SF682xrs	2.5 mm	6 mm	2.6 mm	7.1 mm	0.8 mm	Sealed	Stainless Steel	Stainless Steel	63.9 X 1000 rpm
SF682xzz	2.5 mm	6 mm	2.6 mm	7.1 mm	0.8 mm	Shielded	Stainless Steel	Stainless Steel	63.9 X 1000 rpm
SF692x	2.5 mm	7 mm	2.5 mm	8.5 mm	0.7 mm	Open	Stainless Steel	Stainless Steel	56.7 X 1000 rpm
SF692xrs	2.5 mm	7 mm	3.5 mm	8.5 mm	0.9 mm	Sealed	Stainless Steel	Stainless Steel	56.7 X 1000 rpm
SF692xzz	2.5 mm	7 mm	3.5 mm	8.5 mm	0.9 mm	Shielded	Stainless Steel	Stainless Steel	56.7 X 1000 rpm
SF602x	2.5 mm	8 mm	2.8 mm	9.5 mm	0.7 mm	Open	Stainless Steel	Stainless Steel	54 X 1000 rpm
SF602xrs	2.5 mm	8 mm	4 mm	9.5 mm	0.9 mm	Sealed	Stainless Steel	Stainless Steel	54 X 1000 rpm
SF602xzz	2.5 mm	8 mm	4 mm	9.5 mm	0.9 mm	Shielded	Stainless Steel	Stainless Steel	54 X 1000 rpm
SF683	3 mm	7 mm	2 mm	8.1 mm	0.5 mm	Open	Stainless Steel	Stainless Steel	56.7 X 1000 rpm



SF Series Stainless Steel Flanged Miniature Bearings

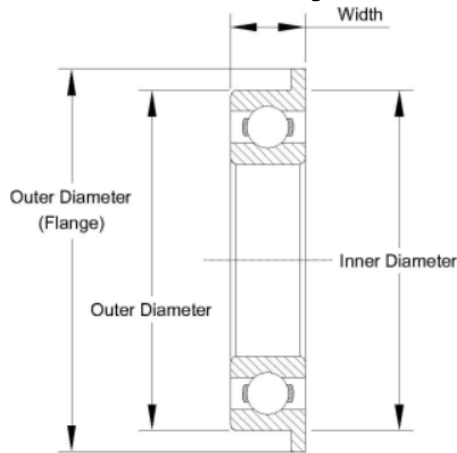

Part Number	Bore diameter	Outside diameter	Width	Flange outer diameter	Flange thickness	Seal type	Ring material	Ball material	Limiting speed
SF683 2rs	3 mm	7 mm	3 mm	8.1 mm	0.8 mm	Sealed	Stainless Steel	Stainless Steel	56.7 X 1000 rpm
SF683zz	3 mm	7 mm	3 mm	8.1 mm	0.8 mm	Shielded	Stainless Steel	Stainless Steel	56.7 X 1000 rpm
SF693	3 mm	8 mm	3 mm	9.5 mm	0.7 mm	Open	Stainless Steel	Stainless Steel	54 X 1000 rpm
SF693 2rs	3 mm	8 mm	4 mm	9.5 mm	0.9 mm	Sealed	Stainless Steel	Stainless Steel	54 X 1000 rpm
SF693zz	3 mm	8 mm	4 mm	9.5 mm	0.9 mm	Shielded	Stainless Steel	Stainless Steel	54 X 1000 rpm
SF603	3 mm	9 mm	3 mm	10.5 mm	0.7 mm	Open	Stainless Steel	Stainless Steel	50.4 X 1000 rpm
SF603 2rs	3 mm	9 mm	3 mm	10.5 mm	0.7 mm	Sealed	Stainless Steel	Stainless Steel	50.4 X 1000 rpm
SF603zz	3 mm	9 mm	5 mm	10.5 mm	0.7 mm	Shielded	Stainless Steel	Stainless Steel	50.4 X 1000 rpm
SF623	3 mm	10 mm	4 mm	11.5 mm	1 mm	Open	Stainless Steel	Stainless Steel	45 X 1000 rpm
SF623 2rs	3 mm	10 mm	4 mm	11.5 mm	1 mm	Sealed	Stainless Steel	Stainless Steel	45 X 1000 rpm
SF623zz	3 mm	10 mm	4 mm	11.5 mm	1 mm	Shielded	Stainless Steel	Stainless Steel	45 X 1000 rpm
SF684	4 mm	9 mm	2.5 mm	10.3 mm	0.6 mm	Open	Stainless Steel	Stainless Steel	47.7 X 1000 rpm
SF684 2rs	4 mm	9 mm	4 mm	10.3 mm	1 mm	Sealed	Stainless Steel	Stainless Steel	47.7 X 1000 rpm
SF684zz	4 mm	9 mm	4 mm	10.3 mm	1 mm	Shielded	Stainless Steel	Stainless Steel	47.7 X 1000 rpm
SF694	4 mm	11 mm	4 mm	12.5 mm	1 mm	Open	Stainless Steel	Stainless Steel	43.2 X 1000 rpm
SF694 2rs	4 mm	11 mm	4 mm	12.5 mm	1 mm	Sealed	Stainless Steel	Stainless Steel	43.2 X 1000 rpm
SF694zz	4 mm	11 mm	4 mm	12.5 mm	1 mm	Shielded	Stainless Steel	Stainless Steel	43.2 X 1000 rpm
SF604	4 mm	12 mm	4 mm	13.5 mm	1 mm	Open	Stainless Steel	Stainless Steel	43.2 X 1000 rpm
SF604 2rs	4 mm	12 mm	4 mm	13.5 mm	1 mm	Sealed	Stainless Steel	Stainless Steel	43.2 X 1000 rpm
SF604zz	4 mm	12 mm	4 mm	13.5 mm	1 mm	Shielded	Stainless Steel	Stainless Steel	43.2 X 1000 rpm
SF624	4 mm	13 mm	5 mm	15 mm	1 mm	Open	Stainless Steel	Stainless Steel	36 X 1000 rpm
SF624 2rs	4 mm	13 mm	5 mm	15 mm	1 mm	Sealed	Stainless Steel	Stainless Steel	36 X 1000 rpm
SF624zz	4 mm	13 mm	5 mm	15 mm	1 mm	Shielded	Stainless Steel	Stainless Steel	36 X 1000 rpm
SF634	4 mm	16 mm	5 mm	18 mm	1 mm	Open	Stainless Steel	Stainless Steel	32.4 X 1000 rpm
SF634 2rs	4 mm	16 mm	5 mm	18 mm	1 mm	Sealed	Stainless Steel	Stainless Steel	32.4 X 1000 rpm
SF634zz	4 mm	16 mm	5 mm	18 mm	1 mm	Shielded	Stainless Steel	Stainless Steel	32.4 X 1000 rpm
SF685	5 mm	11 mm	3 mm	12.5 mm	0.8 mm	Open	Stainless Steel	Stainless Steel	40.5 X 1000 rpm



SF Series Stainless Steel Flanged Miniature Bearings

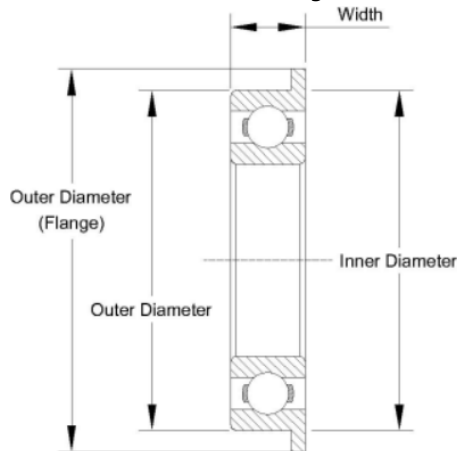

Part Number	Bore diameter	Outside diameter	Width	Flange outer diameter	Flange thickness	Seal type	Ring material	Ball material	Limiting speed
SF685 2rs	5 mm	11 mm	5 mm	12.5 mm	1 mm	Sealed	Stainless Steel	Stainless Steel	40.5 X 1000 rpm
SF685zz	5 mm	11 mm	5 mm	12.5 mm	1 mm	Shielded	Stainless Steel	Stainless Steel	40.5 X 1000 rpm
SF695	5 mm	13 mm	4 mm	15 mm	1 mm	Open	Stainless Steel	Stainless Steel	38.7 X 1000 rpm
SF695 2rs	5 mm	13 mm	4 mm	15 mm	1 mm	Sealed	Stainless Steel	Stainless Steel	38.7 X 1000 rpm
SF695zz	5 mm	13 mm	4 mm	15 mm	1 mm	Shielded	Stainless Steel	Stainless Steel	38.7 X 1000 rpm
SF605	5 mm	14 mm	5 mm	16 mm	1 mm	Open	Stainless Steel	Stainless Steel	36 X 1000 rpm
SF605 2rs	5 mm	14 mm	5 mm	16 mm	1 mm	Sealed	Stainless Steel	Stainless Steel	36 X 1000 rpm
SF605zz	5 mm	14 mm	5 mm	16 mm	1 mm	Shielded	Stainless Steel	Stainless Steel	36 X 1000 rpm
SF625	5 mm	16 mm	5 mm	18 mm	1 mm	Open	Stainless Steel	Stainless Steel	32.4 X 1000 rpm
SF625 2rs	5 mm	16 mm	5 mm	18 mm	1 mm	Sealed	Stainless Steel	Stainless Steel	32.4 X 1000 rpm
SF625zz	5 mm	16 mm	5 mm	18 mm	1 mm	Shielded	Stainless Steel	Stainless Steel	32.4 X 1000 rpm
SF635	5 mm	19 mm	6 mm	22 mm	1.5 mm	Open	Stainless Steel	Stainless Steel	28.8 X 1000 rpm
SF635 2rs	5 mm	19 mm	6 mm	22 mm	1.5 mm	Sealed	Stainless Steel	Stainless Steel	28.8 X 1000 rpm
SF635zz	5 mm	19 mm	6 mm	22 mm	1.5 mm	Shielded	Stainless Steel	Stainless Steel	28.8 X 1000 rpm
SF686	6 mm	13 mm	3.5 mm	15 mm	1 mm	Open	Stainless Steel	Stainless Steel	36 X 1000 rpm
SF686 2rs	6 mm	13 mm	5 mm	15 mm	1.1 mm	Sealed	Stainless Steel	Stainless Steel	36 X 1000 rpm
SF686zz	6 mm	13 mm	5 mm	15 mm	1.1 mm	Shielded	Stainless Steel	Stainless Steel	36 X 1000 rpm
SF696	6 mm	15 mm	5 mm	17 mm	1.2 mm	Open	Stainless Steel	Stainless Steel	36 X 1000 rpm
SF696 2rs	6 mm	15 mm	5 mm	17 mm	1.2 mm	Sealed	Stainless Steel	Stainless Steel	36 X 1000 rpm
SF696zz	6 mm	15 mm	5 mm	17 mm	1.2 mm	Shielded	Stainless Steel	Stainless Steel	36 X 1000 rpm
SF606	6 mm	17 mm	6 mm	19 mm	1.2 mm	Open	Stainless Steel	Stainless Steel	34.2 X 1000 rpm
SF606 2rs	6 mm	17 mm	6 mm	19 mm	1.2 mm	Sealed	Stainless Steel	Stainless Steel	34.2 X 1000 rpm
SF606zz	6 mm	17 mm	6 mm	19 mm	1.2 mm	Shielded	Stainless Steel	Stainless Steel	34.2 X 1000 rpm
SF626	6 mm	19 mm	6 mm	22 mm	1.5 mm	Open	Stainless Steel	Stainless Steel	28.8 X 1000 rpm
SF626 2rs	6 mm	19 mm	6 mm	22 mm	1.5 mm	Sealed	Stainless Steel	Stainless Steel	28.8 X 1000 rpm
SF626zz	6 mm	19 mm	6 mm	22 mm	1.5 mm	Shielded	Stainless Steel	Stainless Steel	28.8 X 1000 rpm
SF687	7 mm	14 mm	3.5 mm	16 mm	1 mm	Open	Stainless Steel	Stainless Steel	36 X 1000 rpm



SF Series Stainless Steel Flanged Miniature Bearings

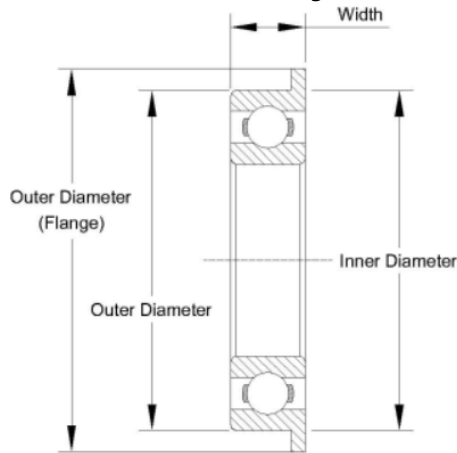

Part Number	Bore diameter	Outside diameter	Width	Flange outer diameter	Flange thickness	Seal type	Ring material	Ball material	Limiting speed
SF687 2rs	7 mm	14 mm	5 mm	16 mm	1.1 mm	Sealed	Stainless Steel	Stainless Steel	36 X 1000 rpm
SF687zz	7 mm	14 mm	5 mm	16 mm	1.1 mm	Shielded	Stainless Steel	Stainless Steel	36 X 1000 rpm
SF697	7 mm	17 mm	5 mm	19 mm	1.2 mm	Open	Stainless Steel	Stainless Steel	32.4 X 1000 rpm
SF697 2rs	7 mm	17 mm	5 mm	19 mm	1.2 mm	Sealed	Stainless Steel	Stainless Steel	32.4 X 1000 rpm
SF697zz	7 mm	17 mm	5 mm	19 mm	1.2 mm	Shielded	Stainless Steel	Stainless Steel	32.4 X 1000 rpm
SF607	7 mm	19 mm	6 mm	22 mm	1.5 mm	Open	Stainless Steel	Stainless Steel	32.4 X 1000 rpm
SF607 2rs	7 mm	19 mm	6 mm	22 mm	1.5 mm	Sealed	Stainless Steel	Stainless Steel	32.4 X 1000 rpm
SF607zz	7 mm	19 mm	6 mm	22 mm	1.5 mm	Shielded	Stainless Steel	Stainless Steel	32.4 X 1000 rpm
SF627	7 mm	22 mm	7 mm	25 mm	1.5 mm	Open	Stainless Steel	Stainless Steel	27 X 1000 rpm
SF627 2rs	7 mm	22 mm	7 mm	25 mm	1.5 mm	Sealed	Stainless Steel	Stainless Steel	27 X 1000 rpm
SF627zz	7 mm	22 mm	7 mm	25 mm	1.5 mm	Shielded	Stainless Steel	Stainless Steel	27 X 1000 rpm
SF688	8 mm	16 mm	4 mm	18 mm	1 mm	Open	Stainless Steel	Stainless Steel	32.4 X 1000 rpm
SF688 2rs	8 mm	16 mm	5 mm	18 mm	1.1 mm	Sealed	Stainless Steel	Stainless Steel	32.4 X 1000 rpm
SF688zz	8 mm	16 mm	5 mm	18 mm	1.1 mm	Shielded	Stainless Steel	Stainless Steel	32.4 X 1000 rpm
SF698	8 mm	19 mm	6 mm	22 mm	1.5 mm	Open	Stainless Steel	Stainless Steel	32.4 X 1000 rpm
SF698 2rs	8 mm	19 mm	6 mm	22 mm	1.5 mm	Sealed	Stainless Steel	Stainless Steel	32.4 X 1000 rpm
SF698zz	8 mm	19 mm	6 mm	22 mm	1.5 mm	Shielded	Stainless Steel	Stainless Steel	32.4 X 1000 rpm
SF608	8 mm	22 mm	7 mm	25 mm	1.5 mm	Open	Stainless Steel	Stainless Steel	30.6 X 1000 rpm
SF608 2rs	8 mm	22 mm	7 mm	25 mm	1.5 mm	Sealed	Stainless Steel	Stainless Steel	30.6 X 1000 rpm
SF608zz	8 mm	22 mm	7 mm	25 mm	1.5 mm	Shielded	Stainless Steel	Stainless Steel	30.6 X 1000 rpm
SF679	9 mm	14 mm	3 mm	15.5 mm	0.8 mm	Open	Stainless Steel	Stainless Steel	32.4 X 1000 rpm
SF679 2rs	9 mm	14 mm	4.5 mm	15.5 mm	0.8 mm	Sealed	Stainless Steel	Stainless Steel	32.4 X 1000 rpm
SF679zz	9 mm	14 mm	4.5 mm	15.5 mm	0.8 mm	Shielded	Stainless Steel	Stainless Steel	32.4 X 1000 rpm
SF689	9 mm	17 mm	4 mm	19 mm	1 mm	Open	Stainless Steel	Stainless Steel	32.4 X 1000 rpm
SF689 2rs	9 mm	17 mm	5 mm	19 mm	1.1 mm	Sealed	Stainless Steel	Stainless Steel	32.4 X 1000 rpm
SF689zz	9 mm	17 mm	5 mm	19 mm	1.1 mm	Shielded	Stainless Steel	Stainless Steel	32.4 X 1000 rpm
SF699	9 mm	20 mm	6 mm	23 mm	1.5 mm	Open	Stainless Steel	Stainless Steel	30.6 X 1000 rpm



SF Series Stainless Steel Flanged Miniature Bearings

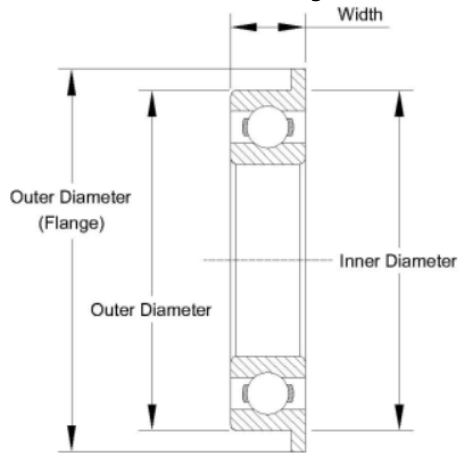

Part Number	Bore diameter	Outside diameter	Width	Flange outer diameter	Flange thickness	Seal type	Ring material	Ball material	Limiting speed
SF699 2rs	9 mm	20 mm	6 mm	23 mm	1.5 mm	Sealed	Stainless Steel	Stainless Steel	30.6 X 1000 rpm
SF699zz	9 mm	20 mm	6 mm	23 mm	1.5 mm	Shielded	Stainless Steel	Stainless Steel	30.6 X 1000 rpm
SF609	9 mm	24 mm	7 mm	27 mm	1.5 mm	Open	Stainless Steel	Stainless Steel	28.8 X 1000 rpm
SF609 2rs	9 mm	24 mm	7 mm	27 mm	1.5 mm	Sealed	Stainless Steel	Stainless Steel	28.8 X 1000 rpm
SF609zz	9 mm	24 mm	7 mm	27 mm	1.5 mm	Shielded	Stainless Steel	Stainless Steel	28.8 X 1000 rpm